

**LINE 6: BARSTOW CITY HALL - BARSTOW COLLEGE**

**SOUTHBOUND**

From E Mountain View St

- (R) Barstow Rd
- (L) Armory Rd
- (R) Montara Rd
- (R) Rimrock Rd
- (R) Broadway Ave
- (L) Center St
- (R) Upton Dr
- (L) Windy Pass
- (L) Muriel Dr
- (R) Rimrock Rd
- (L) Barstow Rd
- (R) Barstow College
- (L) Interior Rd  
to bus stop

**NORTHBOUND**

From Barstow College

- (L) Viking St
- (L) Barstow Rd
- (R) Rimrock Rd
- (L) Muriel Dr
- (R) Windy Pass
- (R) Upton Dr
- (L) Center St
- (R) Broadway Ave
- (L) Rimrock Rd
- (L) Montara Rd
- (L) Armory Rd
- (R) Barstow Rd
- (L) E Buena Vista St
- (L) 2nd Ave
- (L) E Mountain View St  
to bus stop NS Belinda Ave

**LINE 6: BARSTOW CITY HALL - BARSTOW COLLEGE**

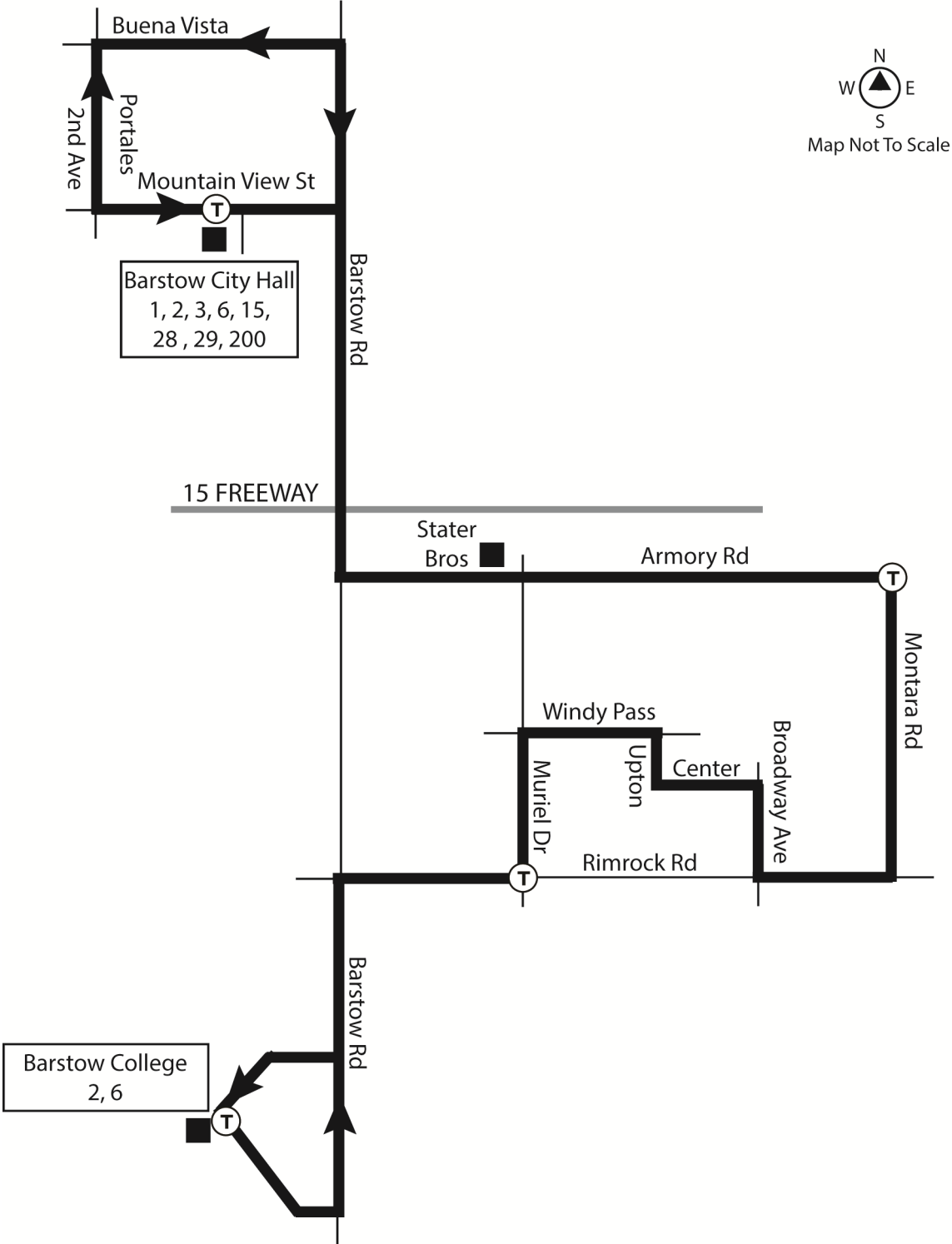

## LINE 6: BARSTOW CITY HALL - BARSTOW COLLEGE

### PULL IN/PULL OUT ROUTES

#### TO BARSTOW CITY HALL:

From Barstow Division, (R) Sandstone Ct, (R) W Main St, (L) 58 Freeway East, (R) 15 Freeway North, (R) Barstow Rd exit, (L) Barstow Rd, (L) E Buena Vista St St, (L) 2nd Ave, (L) E Mountain View St, to bus stop NS Belinda Ave

#### FROM BARSTOW CITY HALL:

via E Mountain View St, (R) Barstow Rd, (R) 15 Freeway South, (R) 58 Freeway West, (R) W Main St exit, (R) W Main St, (L) Sandstone Ct, (L) into Barstow Division.

#### TO BARSTOW COLLEGE:

From Barstow Division, (R) Sandstone Ct, (R) W Main St, (L) 58 Freeway East, (R) 15 Freeway North, (R) Barstow Rd Exit, (R) Barstow Rd, (R) Barstow College, (L) to bus stop.

#### FROM BARSTOW COLLEGE:

via Interior Rd, (L) Viking St, (L) Barstow Rd, (L) 15 Freeway South, (R) 58 Freeway West, (R) W Main St exit, (R) W Main St, (L) Sandstone Ct, (L) into Barstow Division.

#### DESTINATION SIGN CODES:

<b>TERMINAL</b>	<b>DISPLAY</b>	<b>CODE</b>
Barstow City Hall	6 Barstow City Hall	60
Barstow College	6 Barstow College	61
	Not In Service	101